



**Lobster<sup>®</sup> Tools**  
You can feel the difference

## Model EHC-16PCU Cordless Rebar Cutter

Read safety and instructions carefully before using this tool.

**SAVE THIS OWNERS MANUAL & OPERATING INSTRUCTIONS**



Max. Cutting Capacity	#5 (5/8") - Grade 60 rebar
Battery Charger	110-volt input – approx. 20-min charge time
Cuts per charge	40
Weight	14 pounds
Dimensions (L x W x H)	18" x 3 <sup>3</sup> / <sub>4</sub> " x 7 <sup>1</sup> / <sub>2</sub> "

### **Fascut Industries Inc.**

7248 Inama Rd., Sauk City, WI 53583  
Phone: (608)643-6678 Fax: (608)643-2682

**[www.fascut.com](http://www.fascut.com)**

Specifications and prices shown in this document are subject to change at any time.  
For the latest detailed information, please contact Fascut Industries.

## GENERAL SAFETY RULES – FOR ALL POWER TOOLS



### READ ALL INSTRUCTIONS

Failure to follow all instructions listed below may result in electric shock, fire and/or serious injury. The term “power tool” in all of the warnings listed below refers to your mains-operated (corded) power tool or battery-operated (cordless) power tool and charger.

### SAVE THESE INSTRUCTIONS

#### WORK AREA SAFETY

1. **Keep work area clean and well lit.** Cluttered or dark areas invite accidents.
2. **Do not operate power tools in explosive atmospheres, such as in the presence of flammable liquids, gases, or dust.** Power tools create sparks which may ignite the dust or fumes.
3. **Keep children and bystanders away while operating a power tool.** Distractions can cause you to lose control.

#### ELECTRICAL SAFETY

4. **Power tool plugs must match the outlet. Never modify the plug in any way. Do not use any adapter plugs with earthed (grounded) power tools.** Unmodified plugs and matching outlets will reduce risk of electric shock.
5. **Avoid body contact with earthed or grounded surfaces such as pipes, radiators, ranges and refrigerators.** There is an increased risk of electric shock if your body is earthed or grounded.
6. **Do not expose power tools to rain or wet conditions.** Water entering a power tool will increase the risk of electric shock.
7. **Do not abuse the cord. Never use the cord for carrying, pulling, or unplugging the power tool. Keep cord away from heat, oil, sharp edges, or moving parts.** Damaged or entangled cords increase the risk of electric shock.
8. **When operating a power tool outdoors, use an extension cord suitable for outdoor use.** Use of a cord suitable for outdoor use reduces the risk of electric shock.

#### PERSONAL SAFETY

9. **Stay alert, watch what you are doing and use common sense when operating a power tool. Do not use a power tool while you are tired or under the influence of drugs, alcohol or medication.** A moment of inattention while operating power tools may result in serious personal injury.
10. **Use safety equipment. Always wear eye protection.** Safety equipment such as dust mask, non-skid safety shoes, hard hat, or hearing protection used for appropriate conditions will reduce personal injuries.
11. **Avoid accidental starting. Ensure the switch is in the off-position before plugging in.** Carrying tools with your finger on the switch or plugging in power tools that have the switch on invites accidents.
12. **Remove any adjusting key or wrench before turning the power tool on.** A wrench or a key left attached to a rotating part of the power tool may result in personal injury.
13. **Do not overreach. Keep proper footing and balance at all times.** This enables better control of the power tool in unexpected situations.
14. **Dress properly. Do not wear loose clothing or jewellery. Keep your hair, clothing and gloves away from moving parts.** Loose clothes, jewellery, or long hair can be caught in moving parts.
15. **If devices are provided for the connection of dust extraction and collection facilities, ensure these are connected and properly used.** Use of these devices can reduce dust-related hazards.

## **POWER TOOL USE AND CARE**

16. **Do not force the power tool. Use the correct power tool for your application.** The correct power tool will do the job better and safer at the rate for which it was designed.
17. **Do not use the power tool if the switch does not turn it on and off.** Any power tool that cannot be controlled with the switch is dangerous and must be repaired.
18. **Disconnect the plug from the power source and/or the battery pack from the power tool before making any adjustments, changing accessories, or storing power tools.** Such preventive safety measures reduce the risk of starting the tool accidentally.
19. **Store idle power tools out of the reach of children and do not allow persons unfamiliar with the power tools or these instructions to operate power tools.** Power tools are dangerous in the hands of untrained users.
20. **Maintain power tools. Check for misalignment or binding of moving parts, breakage of parts and any other condition that may affect the power tool's operation. If damaged, have the power tool repaired before use.** Many accidents are caused by poorly maintained power tools.
21. **Keep cutting tools sharp and clean.** Properly maintained cutting tools with sharp cutting edges are less likely to bind and are easier to control.
22. **Use the power tool, accessories and tool bits etc., in accordance with these instructions and in the manner intended for the particular type of power tool, taking into account the working conditions and the work to be performed.** Use of the power tool for operations different from those intended could result in a hazardous situation.
23. **Have your power tool serviced by a qualified repair person using only identical replacement parts.** This will ensure that the safety of the power tool is maintained.

## **SERVICE**

## **SPECIFIC SAFETY RULES – FOR CORDLESS REBAR CUTTERS**

1. Never touch the cutting blades or piston during operation.
2. Make it a habit to check that the cutting blades are securely tightened before operation.
3. Remove battery pack from the tool prior to adding hydraulic oil or servicing cutting blades.
4. When battery pack is not in use, keep it away from metal objects like paper clips, coins, keys, nails, screws, or other metal objects that can make a connection from one terminal to another. Shorting the battery terminals together may cause sparks, burns, or a fire.
5. Only use battery pack specifically designed for this tool. Use of any other batteries may create a risk of fire.
6. Only use battery charger specifically designed for this tool's battery pack. A charger suitable for one type of battery may create a risk of fire when used with another battery.
7. Never operate the tool before confirming the DANGEROUS ZONE as shown in the OPERATION section of this manual. Do not point the cutting head towards any person when operating. Cut pieces may fly off with tremendous force and are dangerous. Avoid cutting off small or short pieces of material.
8. Do not attempt to cut material with a size and/or hardness exceeding the maximum cutting capacity.
9. When working in high places, check to make certain no person is under you. Serious injury could result from dropped rebar pieces.
10. If the tool makes an abnormal sound during operation, discontinue use immediately. Return the tool for repair.
11. Do not add hydraulic oil if the tool is warm or immediately after heavy duty operation. Oil will be under a slight pressure when tool is warm.
12. Avoid skin contact, eye contact and inhalation or ingestion of hydraulic oil.
13. Handle tool with care. This rebar cutter is composed of many precision parts, so do not drop or handle roughly. If the tool has been dropped or has received a sharp blow or otherwise damaged in any way, return the tool for repair.
14. Never operate the tool resting upright on its motor.
15. Be sure to hold the tool tightly during operation.

## Parts Identification

- |                     |                                 |                      |
|---------------------|---------------------------------|----------------------|
| 1 – Cutter Head     | 7 – Trigger Switch              | 13 – Release Button  |
| 2 – Fixed Blade     | 8 – Motor                       | 14 – Battery Charger |
| 3 – M4 Cap Screw    | 9 – Oil Cap                     | 15 – M4 Hex Key      |
| 4 – Moving Blade    | 10 – Release Valve              | 16 – Spring Plate    |
| 5 – Adjusting Screw | 11 – Battery Capacity Indicator | 17 – Shoulder Strap  |
| 6 – Piston          | 12 – Battery Pack               |                      |

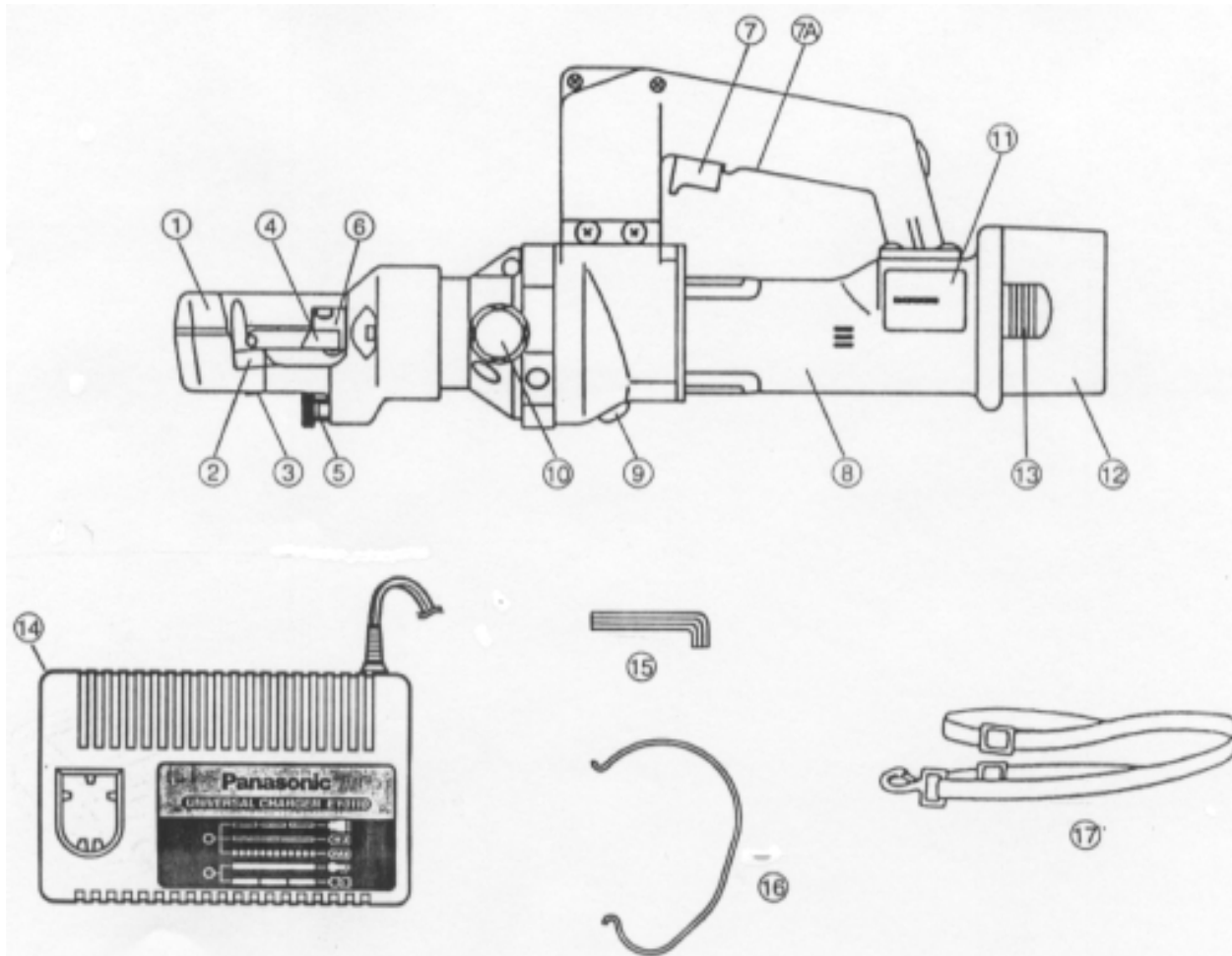

## OPERATION



**Always wear safety goggles or glasses with side shields. Remove battery pack from tool before checking or changing cutting blades or making adjustments.**

### CHECK POINTS FOR OPERATION

#### #1 – Is the work area environment safe?

Do not use and expose this power tool or battery charger in rain or damp/wet locations.



Never use this power tool or charger in the presence of flammable liquids or gases. As with all power tools, sparks are generated and can be very dangerous.



#### #2 - Are Cutting Blades sharp and tight?

Make it a habit to double check that the cutting blades are sharp and securely tightened before operation. Tighten blade securing bolts if they are loose. Be sure to unplug the tool or remove the battery pack before servicing.

#### #3 - Is the electrical power supply correct?

The battery charger is designed to operate on standard household electric power: 120-volts AC.

#### #4 - Using an extension cord?

An extension cord should not be used unless absolutely necessary.

Use of an improper extension cord could result in a risk of fire and electric shock.

If an extension cord must be used, make sure the cord is properly wired, is in good electrical condition, and has a wire size that is large enough for the amperage rating of the charger as specified below.

AWG Size of Cord	16	14
Max Length of Cord	50 feet	100 feet

## CHARGING THE BATTERY

When you charge the battery pack for the first time, or after prolonged storage, charge it for about 24 hours to bring the battery up to full capacity. Just leave the battery pack in the charger for 24 hours even though you will notice the quick green flashing of the charging lamp.

1. Press the battery pack release buttons on both sides and pull out to remove the battery pack from the tool.
2. Plug the charger into the AC outlet. **CAUTION:** Do not use power source from an engine generator. Insert the battery pack firmly into the charger.

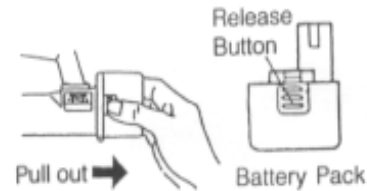

3. During charging, the charging lamp will be lit. When charging is completed, an internal switch will automatically be triggered to prevent overcharging. Note: Charging will not start if the battery is warm (for example, immediately after heavy-duty operation). The orange standby lamp will be lit until the battery cools down. Charging will then begin automatically.

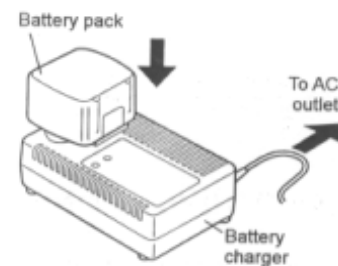

4. When charging is completed, the charging lamp will start flashing green quickly. Remove from the charger and insert into the tool. GENTLY push into place until you hear a “click” sound. If resistance is felt, STOP, back it out and try again.

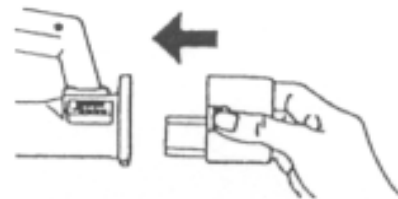

5. Cool down the charger when charging more than two battery packs consecutively.
6. If battery is cold, (below 32° F) warm up to room temperature before charging.
7. Refer to the Operating Instructions supplied with the battery charger for more information and important safety instructions.

Once a recharged battery is inserted in the tool, do not remove it to recharge again until approximately 40 cuts have been made or you notice a definite slow down in cutting action. **Recharging a battery again after only making a few cuts will reduce the life of the battery.**

## LAMP INDICATIONS

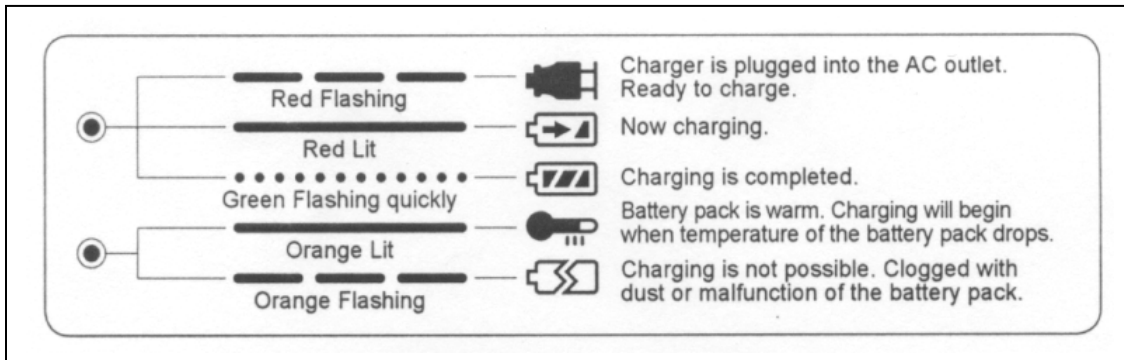

## Operation Procedure

1. Below 32°F, the movement of the cutting blade will be slow and sluggish. Keep the tool in a warm room at 60° or above for about one hour before use. An alternative is to carry out a warming up procedure. To do this, use the Spring Plate (part #16) to continuously run the tool for about 5 minutes without making any cuts. During this time keep unauthorized persons away from the tool. Never use the spring plate for continuous cutting operation.

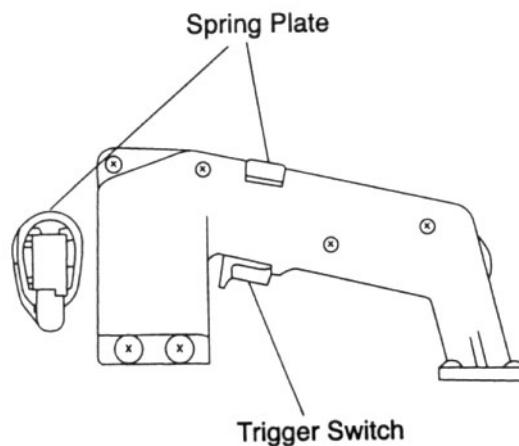

2. Adjust the swivel head to the most convenient operating position.  
(Max. turning angle is 180°clockwise)

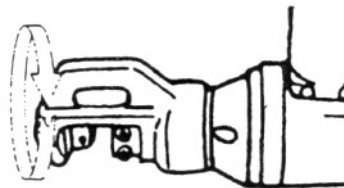

3. Position the rebar to be cut at a right angle to the tool head and secure by adjusting the adjusting screw. This will hold the rebar at a right angle to the cutting direction.

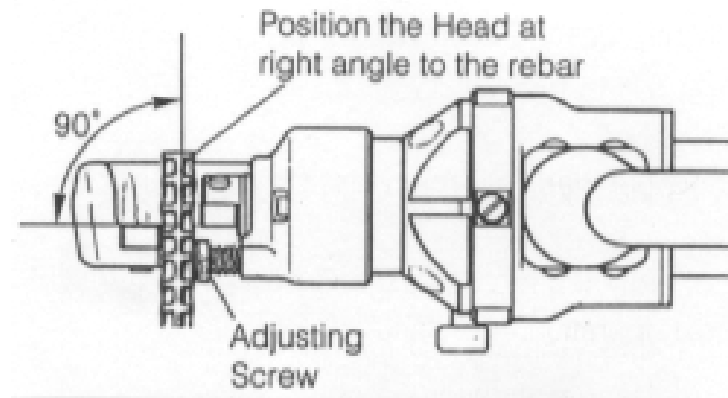

4. Confirm where the **dangerous range** is. Cut pieces may fly off with tremendous force within the **dangerous range** as shown. Operate only after confirming that no one is located in the area of the dangerous range. Avoid cutting material too short.

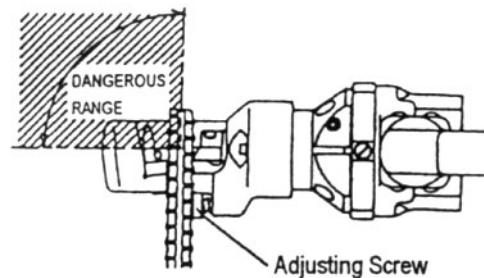

5. Unlock the switch lock if it is locked. Hold the tool firmly and press the trigger switch. The moving cutting blade will advance to cut the rebar.

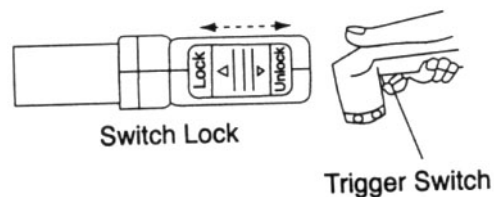

6. The moving cutting blade will automatically retract once fully extended. Release the trigger switch after fully extended and the moving blade will return to the starting position. The tool is now ready for the next cut.

## Emergency Manual Release

For emergency reasons, it may become necessary to manually retract the moving cutting blade. To do this, slightly loosen the Release Valve. The moving blade will return to its starting position. Securely retighten the valve.

**IMPORTANT: Cutter will not cut bars if this release valve is not fully closed.**

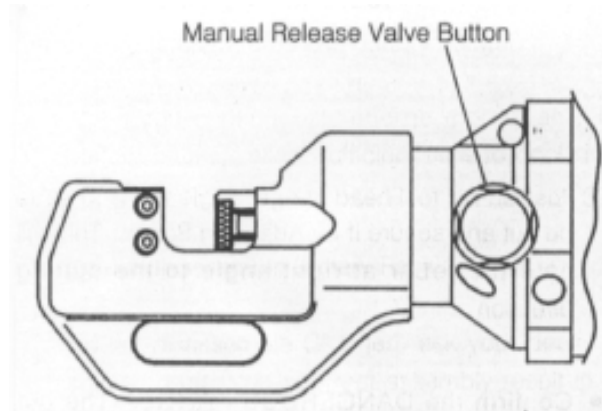

1. Do not point the head towards any person during operation.
2. Do not touch the blades during operation.
3. Do not cut materials too short.
4. Do not cut materials having a hardness exceeding the maximum capacity.
5. Do not operate or rest the tool upright on a work surface.

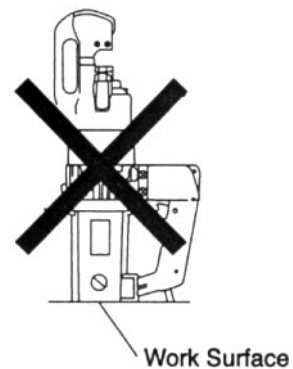
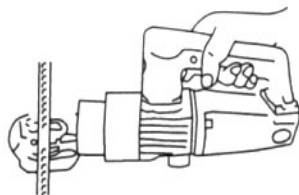

## Maintenance

**Changing the blades** If a blade is dull or damaged, immediately replace with a new blade. Cutting with dull or loose blades **WILL** damage the tool. Remove the battery before starting maintenance of any kind.

1. Loosen and remove the M4 cap screws to remove the fixed and movable cutting blades.
2. The fixed cutting blade is reversible and can be rotated to 4 different cutting edges.
3. The movable cutting blade has only 1 cutting edge.
4. Often check that the cap screws holding the blades are tight. Blade life will be reduced and damage to the tool will result from using the tool with loose cutting blade screws.

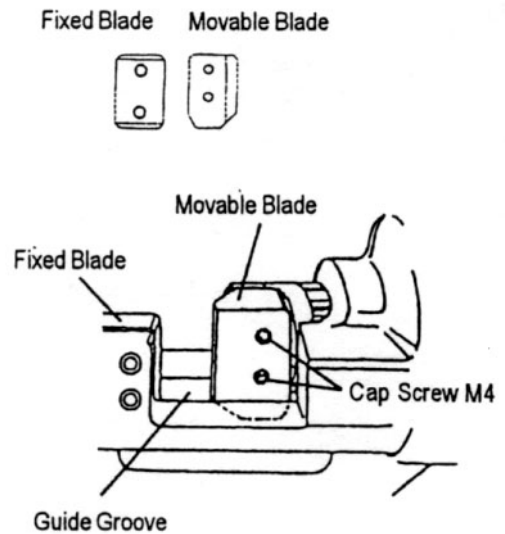

**Clean the Guide Groove** for the movable blade regularly.

**Check the oil every six months.** Only use hydraulic oil with a **VG 32 weight** rating. If not available in your area, order from Fascut Industries.

1. Make certain moving cutting blade is fully retracted.
2. Remove the battery and position so the oil cap faces upward. (see Fig.3)
3. Remove the oil cap using an M6 Hex Key Wrench.
4. Fill the oil to the point of over flow.
5. Replace oil cap and tighten.

**Caution** – Do not add oil if the tool is warm or immediately after heavy duty operation. Care should be taken to prevent hydraulic oil from entering the motor housing.

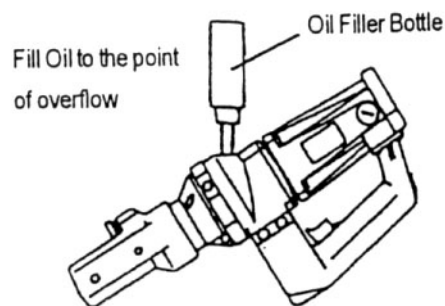
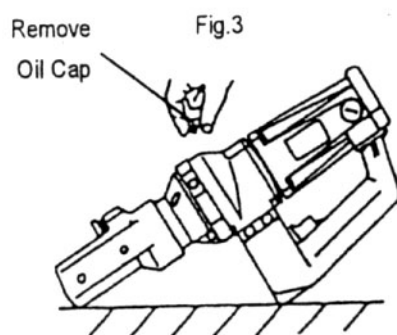

## Storage Method

The tool should be stored in a dry, high or locked up place out of reach of children. Clean prior to long term storage. Coat metal parts with a rust inhibitor.

## Recycle Spent Batteries

This product uses nickel cadmium batteries which are recyclable. Under some state and local laws, it is illegal to dispose of this battery as municipal waste. Call (678)419-9990 or go to [www.rbrc.org](http://www.rbrc.org) to locate a drop off point near you.



## Trouble Shooting

If the remedy listed below does not solve the problem, the tool **MUST** be returned for service. This tool requires special tools and training to disassemble. Disassembly of tool by unauthorized personal will void the warranty.

TROUBLE	PROBABLE CAUSE	REMEDY
Motor will not start.	<ol style="list-style-type: none"><li>1. Battery is spent.</li><li>2. Trigger switch bad.</li><li>3. Battery contacts are bent or broken.</li><li>4. Motor is burnt out.</li></ol>	<ol style="list-style-type: none"><li>1. Replace battery.</li><li>2. Replace trigger switch.</li><li>3. Send back for repair.</li><li>4. Send back for repair.</li></ol>
Charging lamp on charger does not light when plugged in.	<ol style="list-style-type: none"><li>1. Power is off.</li><li>2. Power cord is damaged.</li><li>3. Charger is bad.</li></ol>	<ol style="list-style-type: none"><li>1. Check power supply.</li><li>2. Repair power cord or send back charger for repair.</li><li>3. Purchase new charger.</li></ol>
Freshly charged battery only lasts a few cuts.	<ol style="list-style-type: none"><li>1. Battery is spent.</li></ol>	<ol style="list-style-type: none"><li>1. Replace battery.</li></ol>
Moving blade does not return to the starting position.	<ol style="list-style-type: none"><li>1. Moving blade has not reached fully extended position.</li><li>2. Chip contaminants are jammed in the blade area.</li><li>3. Moving blade is broken or damaged.</li><li>4. Oil piston is bent.</li></ol>	<ol style="list-style-type: none"><li>1. Pull trigger again until fully extended; then release trigger.</li><li>2. Remove blades and clean the blade area and blade sockets.</li><li>3. Replace moving blade.</li><li>4. Send back for repair.</li></ol>
No power to cut.	<ol style="list-style-type: none"><li>1. Emergency release valve is open.</li><li>2. Moving blade is not fully returning to starting position.</li></ol>	<ol style="list-style-type: none"><li>1. Close the emergency release valve.</li><li>2. See trouble remedies listed above.</li></ol>
Cutting speed is slow.	<ol style="list-style-type: none"><li>1. Emergency release valve is open.</li><li>2. Battery is weak.</li><li>3. Hydraulic oil is too hot.</li></ol>	<ol style="list-style-type: none"><li>1. Close the emergency release valve.</li><li>2. Recharge battery.</li><li>3. Stop using tool. Allow it to cool down.</li></ol>

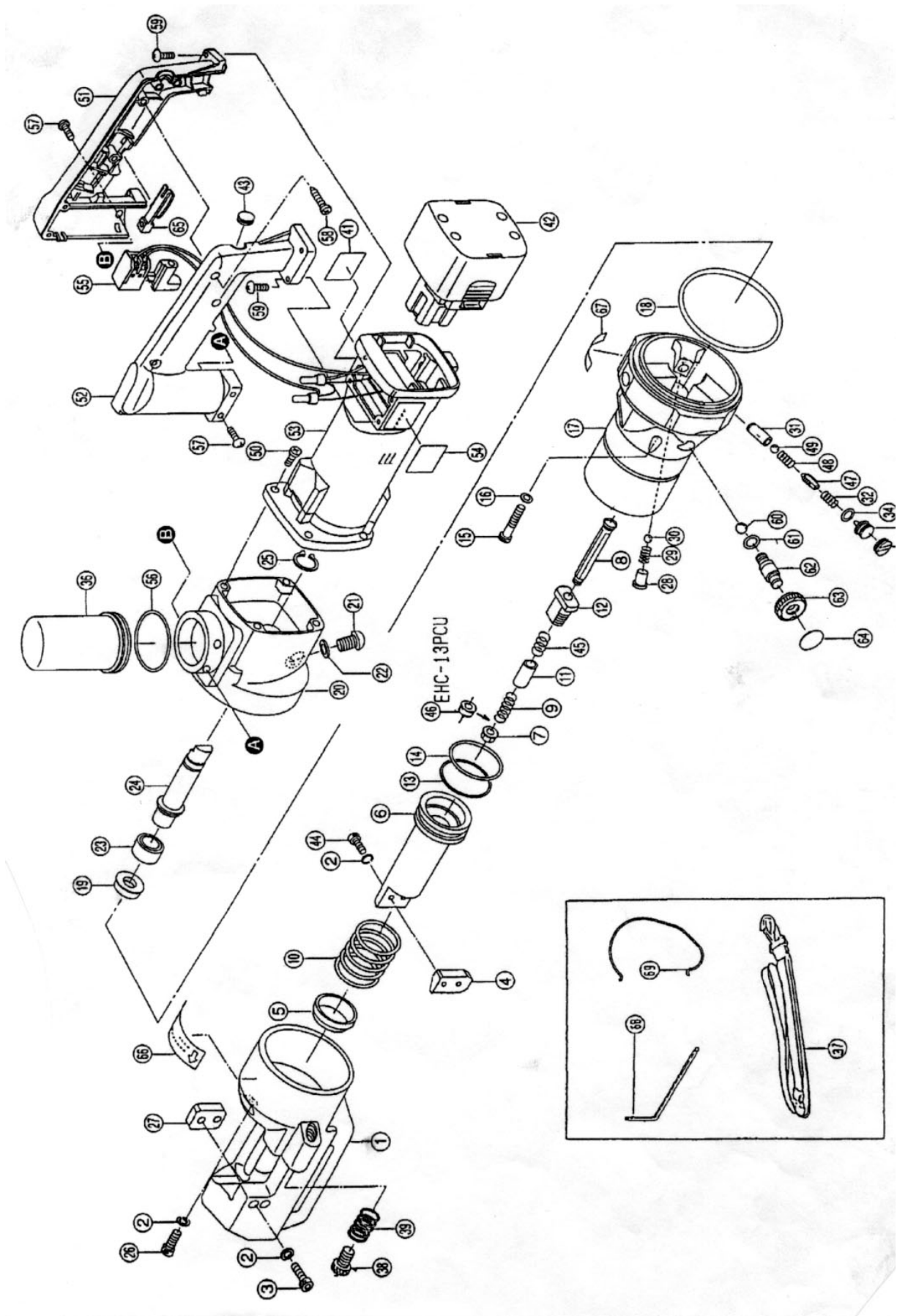

## Lobster EHC-16PCU and EHC/13PCU

Fascut Industries Inc.

March 1, 2011

Index #	Description	Code	Price Ea.	Qty. Req.
1	Cutter Head, -16PCU	26035	\$511.50	1
1.1	Cutter Head, -13PCU	26052	\$405.90	1
2	Washer, Spring Lock, M4	16275	\$0.15	5
3	Screw, Socket Head Cap, M4x18	23592	\$0.40	2
4	Cutting Blade, Moving w/bolts & washers	26042	\$32.50	1
5	Dust Seal	22394	\$12.30	1
6	Oil Piston (only)	26048	\$78.40	1
6.1	Return Valve, includes #7,8,9,11,12,45	26070	76.70	1
7	Hex Nut w/flange, M6	22858	\$0.30	1
8	Valve Shaft	22420	\$39.60	1
9	Spring, Valve (A)	22413	\$3.60	1
10	Spring, Returning	40522	\$19.28	1
11	Collar	22386	\$11.10	1
12	Guide	22406	\$16.40	1
13	Backup Ring, P-39	12380	\$2.10	1
14	O-ring Seal, P-39	12379	\$0.50	1
15	Screw, Socket Head Cap, M5x35	20355	\$0.60	7
16	Washer, Sealing	20356	\$2.70	6
17	Pump Frame (frame only)	24549	\$831.00	1
18	O-ring, frame body, S-80	20354	\$3.60	1
19	Washer, Thrust	23630	\$14.52	1
20	Oil Tank Case Housing	22902	\$233.94	1
20.1	Magnet	24303	\$6.60	3
20.2	Screw, Flat Head Phillips, M4x8	24304	\$0.20	3
21	Screw, Hex Socket Button Head, M10x16	20362	\$2.40	1
22	Washer, Sealing	25591	\$4.80	1
23	Bearing, Needle	22901	\$32.18	1
24	Spindle, EHC-16PCU	23882	\$49.19	1
24.1	Spindle, EHC-13PCU	23881	\$49.19	1
25	Axis Retaining Ring, STW-15	22904	\$0.74	1
26	Screw, Socket Head Cap, M4x10, 16PCU	22421	\$0.30	1
27	Cutting Blade, Fixed w/bolts & washers	26045	\$32.50	1
28	Exhaust Spring Retainer	12432	\$11.70	3
29	Spring, Exhaust	12431	\$0.90	3
30	Steel Ball, 4.8 mm	12360	\$0.20	3
31	Plunger (see item #71)	26018	\$0.00	
32	Spring, Plunger	22918	\$6.30	3
33	Cylinder Cap	20360	\$4.80	3
34	O-ring, Cylinder Cap, P-5	12120	\$0.35	3
35	Head Cap	20359	\$8.70	3
36	Oil Tank	20349	\$17.93	1

37	Shoulder Strap	20392	\$18.80	1
38	Screw, Adjust	22379	\$10.80	1
39	Spring, Adjust Screw, -16PCU	22591	\$3.90	1
39.1	Spring, Adjust Screw, -13PCU	23587	\$3.90	1
40	xxx	xxx	\$0.00	
41	Label, Main Name Plate, EHC-16PCU	26059	\$2.70	1
41.1	Label, Main Name Plate, EHC-13PCU	26066	\$2.70	1
42	Battery Pack, 12-volt	26060	\$121.00	2
43	Switch Handle Cap	23590	\$5.70	1
44	Screw, Socket Head Cap, M4x14	22862	\$0.30	2
45	Spring, Valve (B)	28028	\$5.70	1
46	Washer, EHC-13PCU	22416	\$3.90	1
47	Screw, Intake Valve (see item #71)	26019	\$0.00	
48	Spring, Intake Valve (see item #71)	22921	\$0.00	
49	Steel Ball, 3mm, -16PCU	12355	\$0.35	1
50	Screw, Phillips Head, M5x16	22925	\$0.30	4
51	Switch Handle (R)	27915	\$34.90	1
52	Switch Handle (L)	27916	\$34.90	1
53	Motor Unit, complete	23589	\$526.12	1
53.1	Motor, 12-volt only	22912	\$189.00	1
53.2	Motor Housing (R)	22928	\$22.19	1
53.3	Motor Housing (L)	23588	\$22.19	1
53.4	Battery Terminal Connector Block	22913	\$19.60	1
54	Label, Capacity Indicator	26061	\$2.40	1
55	Trigger Switch	22917	\$29.76	1
56	O-ring, Oil Tank, P-34	24311	\$0.90	1
57	Screw, Phillips Head, M5x20	24312	\$0.30	4
58	Screw, Phillips Head Tapping, M4x20	24313	\$0.25	4
59	Screw, Phillips Head Tapping, M5x16	24321	\$0.80	4
60	Steel Ball, Relief Valve, 5.5mm	12349	\$0.60	1
61	O-ring, P-7	10149	\$0.40	1
62	Relief Valve w/ #63 Button	25565	\$24.66	1
63	xxx	xxx	\$0.00	
64	Label, Relief Valve	26153	\$3.60	1
65	Trigger Switch Stopper	26072	\$4.80	1
66	Label (adjust screw)	26062	\$3.30	1
67	Label, Max #5, -16PCU	26063	\$2.40	1
67.1	Label, Max #4, -13PCU	26067	\$2.40	1
68	Wrench, Hex Key, 4mm	22872	\$1.20	1
69	Trigger Switch Spring Plate	26698	\$8.10	1
71	Plunger Unit, #s 31,47,48,49	26027	\$44.38	3
72	Oil, 12-oz ISO-32	Oil32	\$9.00	
73	Battery Charger, 110-volt	26151	\$133.00	
76	Wrench, Hex Key, 6mm	22873	\$2.40	1